

# RACCORDI A 3 PEZZI PER TERMOSIFONI

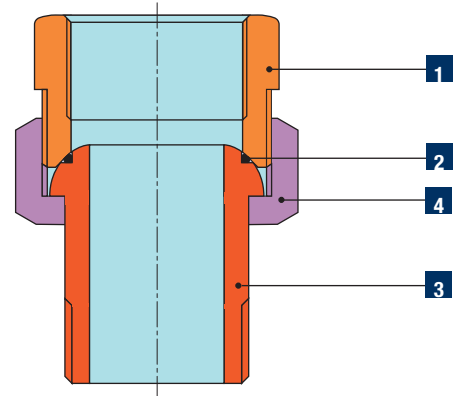

Denominazione	Pz.	Materiale
<b>1</b> Corpo	1	UNI EN 12165 CW617N - DW
<b>2</b> O-Ring di tenuta	1	NBR 70 Sh A (ASTM D 2240)
<b>3</b> Codolo	1	UNI EN 12165 CW617N - DW UNI EN 12164 CW617N - DW
<b>4</b> Dado	1	UNI EN 12165 CW617N - DW UNI EN 12164 CW617N - DW

Limiti di temperatura

From -20 °C to +100 °C

Filettature femmina e maschio

UNI EN ISO 228/1 (DIN 259)

GP 2067  
RACCORDI



Raccordo diritto Femmina-Maschio con tenuta conica, sabbiato.

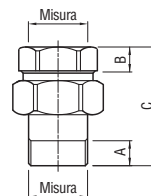

CODICE	Misura	A mm	B mm	C mm	gr	Conf. pz/sc	Master pz/sc
07040012	1/2"	11	12	47	93	50	400
07040034	3/4"	11	12	51	169	30	240
07040100	1"	15	15	59	293	15	120
07040114	1"1/4	15	15	64	428	8	64

GP 2067  
RACCORDI



Raccordo curvo Femmina-Maschio con tenuta conica, sabbiato.

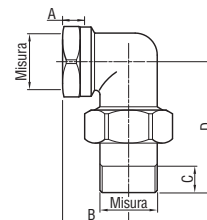

CODICE	Misura	A mm	B mm	C mm	D mm	gr	Conf. pz/sc	Master pz/sc
07050012	1/2"	10	23	10	50	139	30	240
07050034	3/4"	10	29	12	56	228	16	128
07050100	1"	12	34	14	63	374	8	64
07050114	1"1/4	12	34	16	73	518	6	48

GP 2067  
RACCORDI



Raccordo diritto Femmina-Maschio con tenuta conica, nichelato.

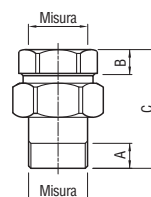

CODICE	Misura	A mm	B mm	C mm	gr	Conf. pz/sc	Master pz/sc
07041012	1/2"	11	12	47	93	50	400
07041034	3/4"	11	12	51	169	30	240
07041100	1"	15	15	59	293	15	120
07041114	1"1/4	15	15	64	428	8	64

GP 2067  
RACCORDI



Raccordo curvo Femmina-Maschio con tenuta conica, nichelato.

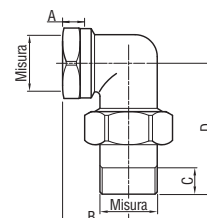

CODICE	Misura	A mm	B mm	C mm	D mm	gr	Conf. pz/sc	Master pz/sc
07051012	1/2"	10	23	10	50	139	30	240
07051034	3/4"	10	29	12	56	228	16	128
07051100	1"	12	34	14	63	374	8	64
07051114	1"1/4	12	34	16	73	518	6	48