

# INTEGRAL

RACCORDI A STRINGERE

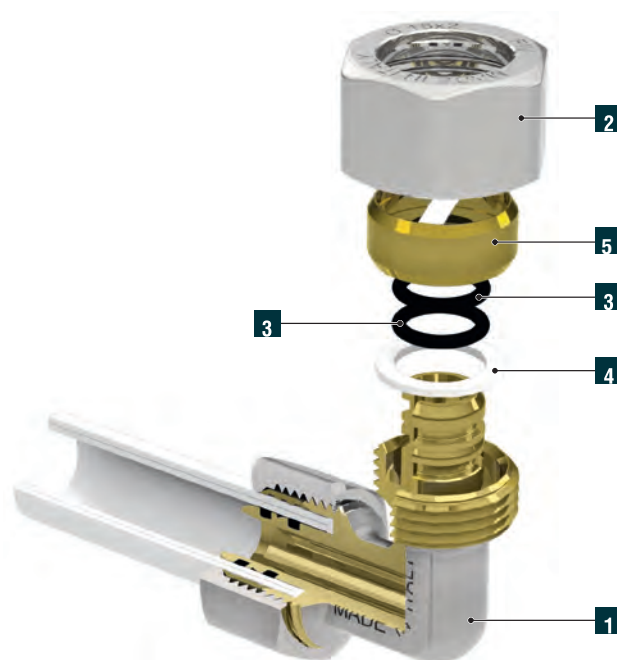

## Denominazione

	Pz.	Materiale
<b>1</b> Corpo in ottone (nichelatura solo su superfici non a contatto con fluidi trasportati)	1	UNI EN 12165 CW617N - DW UNI EN 12164 CW617N - DW
<b>2</b> Dado	1	UNI EN 12165 CW617N - DW UNI EN 12164 CW617N - DW
<b>3</b> Doppio O-Ring	2	EPDM peroxide 70 SH
<b>4</b> Rondella	1	Polietilene
<b>5</b> Ogiva	1	UNI EN 12164 CW617N - DW

## IT CARATTERISTICHE TECNICHE E COSTRUTTIVE

I raccordi INTEGRAL permettono l'installazione veloce e sicura e soprattutto con una ridotta attrezzatura; gli articoli sono dotati di due o-ring in EPDM che garantisce la tenuta in combinazione con il profilo a dente di sega del portagomma stesso, più anello in PTFE per eliminare eventuali correnti vaganti.

### IDONEITÀ POTABILE

I raccordi a stringere INTEGRAL sono conformi al Decreto del Ministero della Salute n. 174 del 06/04/2004.

### COPPIE DI SERRAGGIO

Misura tubo 16x2 - Coppia massima 18-20 Nm

Misura tubo 20x2 - Coppia massima 22-25 Nm

Misura tubo 26x3 - Coppia massima 25-30 Nm

GP 2605  
INTEGRAL

Raccordo diritto femmina, nichelato.

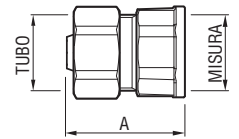

CODICE	Misura	Tubo	A mm	Conf. pz/sc	Master pz/sc
9220R802	16 x 1/2"	16x2	35	10/150	600
9220R804	20 x 1/2"	20x2	33	10/100	400
9220R807	20 x 3/4"	20x2	38	10/60	240
9220R809	26 x 3/4"	26x3	39	5/50	200
9220R811	26 x 1"	26x3	42	5/50	200

GP 2605  
INTEGRAL

Raccordo diritto maschio, nichelato.

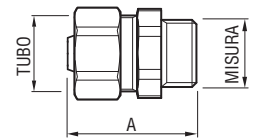

CODICE	Misura	Tubo	A mm	Conf. pz/sc	Master pz/sc
9221R802	16 x 1/2"	16x2	35	10/150	600
9221R804	20 x 1/2"	20x2	36	10/100	400
9221R807	20 x 3/4"	20x2	36	10/100	400
9221R809	26 x 3/4"	26x3	39	5/50	200
9221R811	26 x 1"	26x3	43	5/50	200

GP 2605  
INTEGRAL

Raccordo gomito femmina, nichelato.

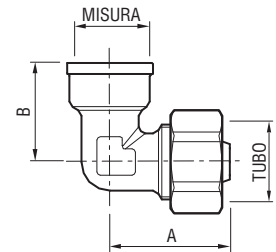

CODICE	Misura	Tubo	A mm	B mm	Conf. pz/sc	Master pz/sc
9222R802	16 x 1/2"	16x2	27	33	10/100	400
9222R804	20 x 1/2"	20x2	30	36	10/60	240
9222R807	20 x 3/4"	20x2	32	36	10/60	240
9222R809	26 x 3/4"	26x3	42	38	5/30	120

GP 2605  
INTEGRAL

Raccordo gomito maschio, nichelato.

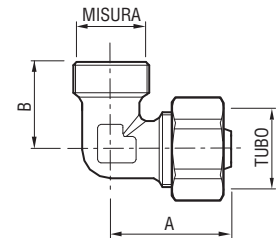

CODICE	Misura	Tubo	A mm	B mm	Conf. pz/sc	Master pz/sc
9223R802	16 x 1/2"	16x2	25	33	10/100	400
9223R804	20 x 1/2"	20x2	29	36	10/60	240
9223R807	20 x 3/4"	20x2	31	36	10/60	240
9223R809	26 x 3/4"	26x3	39	38	5/30	120

GP 2605  
INTEGRAL

Raccordo gomito femmina, con flangia, nichelato.

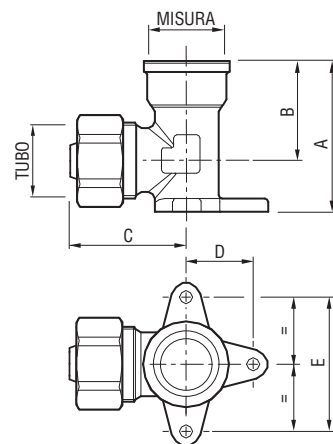

CODICE	Misura	Tubo	A mm	B mm	C mm	D mm	E mm	Conf. pz/sc	Master pz/sc
9224R802	16 x 1/2"	16x2	40	27	34	17	34	10/50	200
9224R804	20 x 1/2"	20x2	40	27	35	17	34	5/30	120

GP 2605  
INTEGRAL

Raccordo a T, intermedio con derivazione femmina, nichelato.

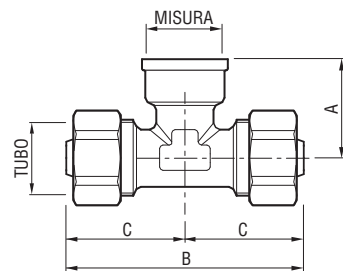

CODICE	Misura	Tubo	A mm	B mm	C mm	Conf. pz/sc	Master pz/sc
9225R817	16 x 1/2" x 16	16x2	27	66	33	10/50	200
9225R819	20 x 1/2" x 20	20x2	30	72	36	5/30	120
9225R822	20 x 3/4" x 20	20x2	32	72	36	5/30	120
9225R823	26 x 3/4" x 26	26x3	42	76	38	5/20	80

GP 2605  
INTEGRAL

Raccordo diritto, intermedio, nichelato.

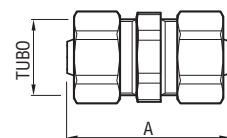

CODICE	Misura	Tubo	A mm	Conf. pz/sc	Master pz/sc
9226R829	16 x 16	16x2	43	10/100	400
9226R831	20 x 20	20x2	44	10/50	200
9226R833	26 x 26	26 x 3	50	5/30	120

GP 2605  
INTEGRAL

Raccordo diritto, intermedio ridotto, nichelato.

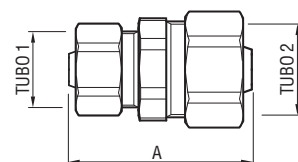

CODICE	Misura	Tubo 1	Tubo 2	A mm	Conf. pz/sc	Master pz/sc
9227R841	16 x 20	16x2	20x2	43	10/70	280
9227R845	20 x 26	20x2	26x3	48	5/50	200

GP 2605  
INTEGRAL



Raccordo gomito, intermedio, nichelato.

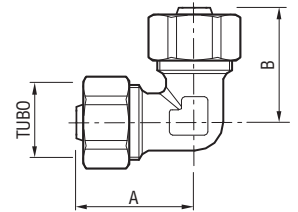

CODICE	Misura	Tubo	A mm	B mm	Conf. pz/sc	Master pz/sc
9228R829	16 x 16	16x2	34	34	10/100	400
9228R831	20 x 20	20x2	36	36	10/60	240
9228R833	26 x 26	26x3	38	48	5/30	120

GP 2605  
INTEGRAL



Raccordo a T, intermedio, nichelato.

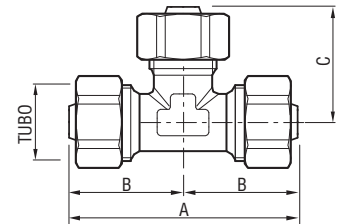

CODICE	Misura	Tubo	A mm	B mm	C mm	Conf. pz/sc	Master pz/sc
9229R852	16 x 16 x 16	16x2	72	36	36	10/50	200
9229R854	20 x 20 x 20	20x2	72	36	36	5/30	120
9229R856	26 x 26 x 26	26x3	76	38	48	5/15	60

GP 2605  
INTEGRAL



Raccordo a T, intermedio ridotto, nichelato.

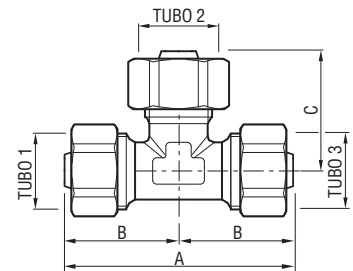

CODICE	Misura	Tubo 1	Tubo 2	Tubo 3	A mm	B mm	C mm	Conf. pz/sc	Master pz/sc
9230R861	16 x 20 x 16	16x2	20x2	16x2	72	36	36	5/30	120
9230R874	16 x 20 x 20	16x2	20x2	20x2	72	36	36	5/30	120
9230R885	26 x 20 x 26	26x3	20x2	26x3	76	38	43	5/15	60

GP 2605  
INTEGRAL



Raccordo a T, intermedio con derivazione maschio, nichelato.

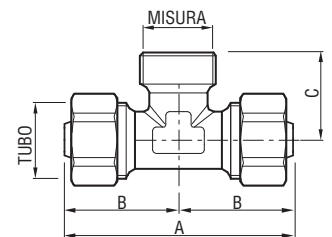

CODICE	Misura	Tubo	A mm	B mm	C mm	Conf. pz/sc	Master pz/sc
9231R817	16 x 1/2" x 16	16x2	68	34	24	10/50	200
9231R819	20 x 1/2" x 20	20x2	72	36	29	5/30	120
9231R822	20 x 3/4" x 20	20x2	72	36	30	5/30	120

GP 2605  
INTEGRAL

Raccordo a 105° femmina, nichelato.

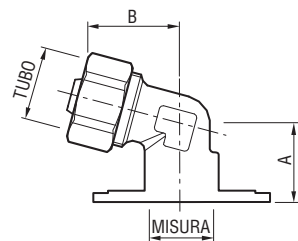

CODICE	Misura	Tubo	A mm	B mm	Conf. pz/sc	Master pz/sc
9232R802	16 x 1/2"	16x2	21	30	5/50	200

GP 2605  
INTEGRAL

Raccordo a 105° femmina, lungo, nichelato.

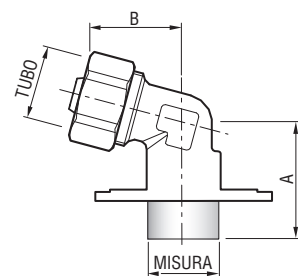

CODICE	Misura	Tubo	A mm	B mm	Conf. pz/sc	Master pz/sc
9232R902	16 x 1/2"	16x2	38	30	5/50	200

GP 2799  
INTEGRAL

Dado attacco 1/2", nichelato.

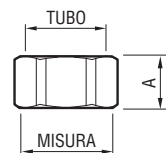

CODICE	Misura	Tubo	A mm	Conf. pz/sc	Master pz/sc
4800R016	16	16x2	13	20/240	960
4800R020	20	20x2	14	10/200	800
4800R026	26	26x3	18	5/100	400

GP 2799  
INTEGRAL

Ogiva.

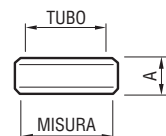

CODICE	Misura	Tubo	A mm	Conf. pz/sc	Master pz/sc
5787L016	16	16x2	8	20/240	960
5787L020	20	20x2	8	10/200	800
5787L026	26	26x3	11	5/100	400