

REGOLO EVO

MECHANICAL THERMOSTAT



EN GENERAL CHARACTERISTICS

Gas expansion sensible element

Temperature limiting/blocking device

Protection class: IP 20

Contact's rating at 250 V: 16 (2,5) A or 10 (1,5) A
(dependent of the model)

Temperature range: from 5 to 30 °C

Temperature differential: $\Delta T \leq 1^\circ\text{C}$

Thermal gradient: 1 °C/15 min

Delegated Regulation (EU) n. 811/2013; annex IV-3:

- Class of the temperature control device: Class 1: Class I
- Contribution of the temperature control device to the seasonal energy efficiency of environment heating in %: 1%

GP 2792
REGOLO EVO

Mechanical ambient thermostat.

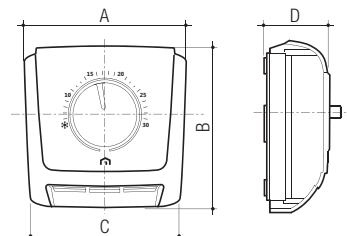

CODE	A mm	B mm	C mm	D mm	Type	Pack pcs/box
6323R001	83,7	82,9	76,5	30,9	3 contacts without signal light	1
6323R002	83,7	82,9	76,5	30,9	3 contacts with signal light	1
6323R003	83,7	82,9	76,5	30,9	3 contacts with signal light and on/off switch	1
6323R004	83,7	82,9	76,5	30,9	2 contacts with signal light and winter/summer switch	1